



6216-Z Deep groove ball bearings

- SKF Explorer

Deep groove ball bearings

Bearing data

[Tolerances](#),

Normal (metric), P6, P5, Normal (inch),

[Radial internal clearance](#),

Matched bearing pairs, Stainless steel
 $d < 10$ mm, Other bearings

Bearing interfaces

[Seat tolerances for standard conditions](#),

[Tolerances and resultant fits](#)

Technical specification

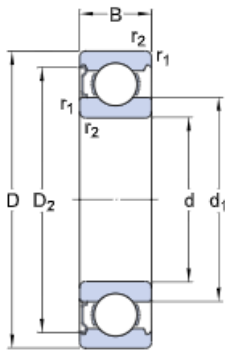

DIMENSIONS

d	80 mm	Bore diameter
D	140 mm	Outside diameter
B	26 mm	Width
d_1	≈ 101.4 mm	Shoulder diameter
D_2	≈ 126.5 mm	Recess diameter
$r_{1,2}$	min. 2 mm	Chamfer dimension

ABUTMENT DIMENSIONS

d_{ξ} min.	91 mm	Diameter of shaft abutment
d_{ξ} max.	100.9 mm	Diameter of shaft abutment
D_{ξ} max.	129 mm	Diameter of housing abutment
r_a max.	2 mm	Radius of shaft or housing fillet

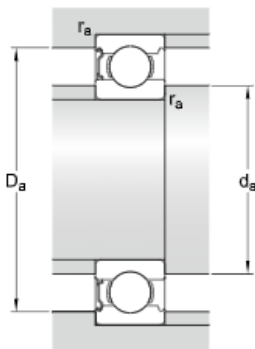

CALCULATION DATA

C	72.8 kN	Basic dynamic load rating
C ₀	55 kN	Basic static load rating
P _u	2.2 kN	Fatigue load limit
	9 500 r/min	Reference speed
	6 000 r/min	Limiting speed
k _r	0.025	Minimum load factor
f ₀	15	Calculation factor

MASS

	1.49 kg	Mass bearing
--	---------	--------------

TOLERANCE CLASS

P6	Dimensional tolerances
Normal	Radial run-out